

smartwin compact EIFS concrete (WDVS Beton)
blindframe (Blindstock)



U_{1D} Wall	0,167	W/m ² K
U_{2D} Window	0,759	W/m ² K
U_{2D}	0,296	W/m ² K

Length S1	1,500	m
Length S2	0,400	m
Total length	1,900	m

L_{1D}	0,553	W/mK
L_{2D}	0,563	W/mK

Ψ_e 0,010 W/mK

projected X
projected X

PHI				
Boundary Conditions	R _s	θ	R _s	θ
	0,13	20,00	0,25	20,00
	0,13	20,00	0,20	20,00
	0,04	-10,00	0,04	-10,00
	Psi-value		fR _{si}	

lowest interior temperature:
f_{RSI} at 20 °C / -10 °C

12,8°C
0,76

> 0,7 requirement fulfilled

Isotherms:

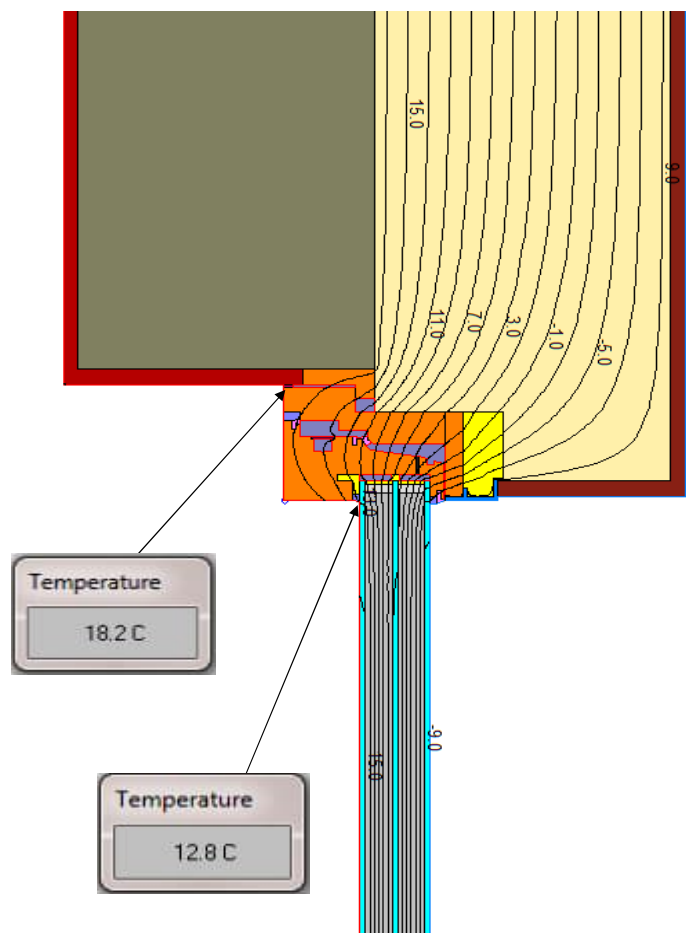
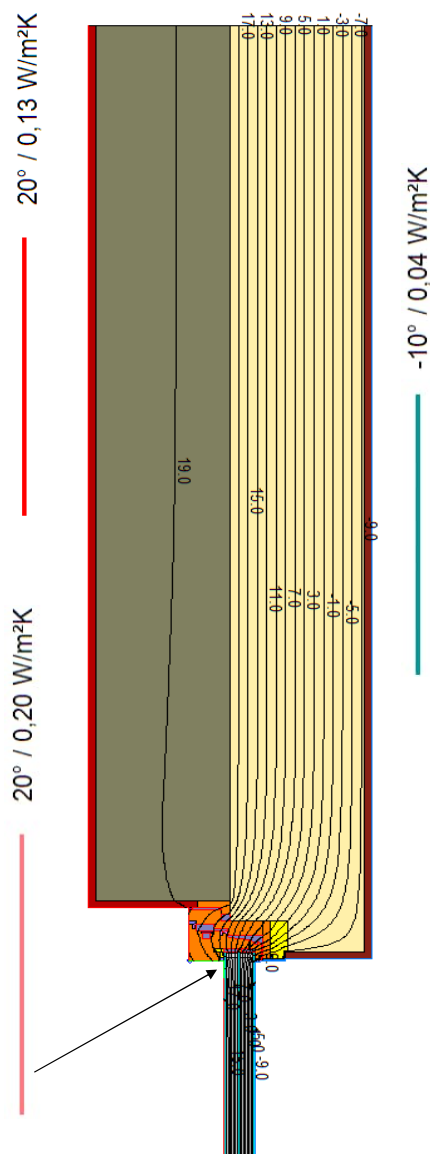

Date	04.08.2018
Signature	

smartwin compact EIFS concrete (WDVS Beton)
venetian blind (Rafflamelle) blindframe (Blindstock)

U_{1D} Wall	0,167	W/m ² K
U_{2D} Window	0,759	W/m ² K
U_{2D}	0,334	W/m ² K



Length S1	1,500	m
Length S2	0,400	m
Total length	1,900	m

L_{1D}	0,553	W/mK
L_{2D}	0,635	W/mK

Ψ_e	0,082	W/mK
----------	-------	------

lowest interior temperature:
 f_{RSi} at 20 °C / -10 °C

projected X
projected X

PHI				
Boundary Conditions	R_s	θ	R_s	θ
	0,13	20,00	0,25	20,00
	0,13	20,00	0,20	20,00
	0,04	-10,00	0,04	-10,00
Psi-value			fR_{si}	

12,5°C
0,75 > 0,7 requirement fulfilled

Isotherms:

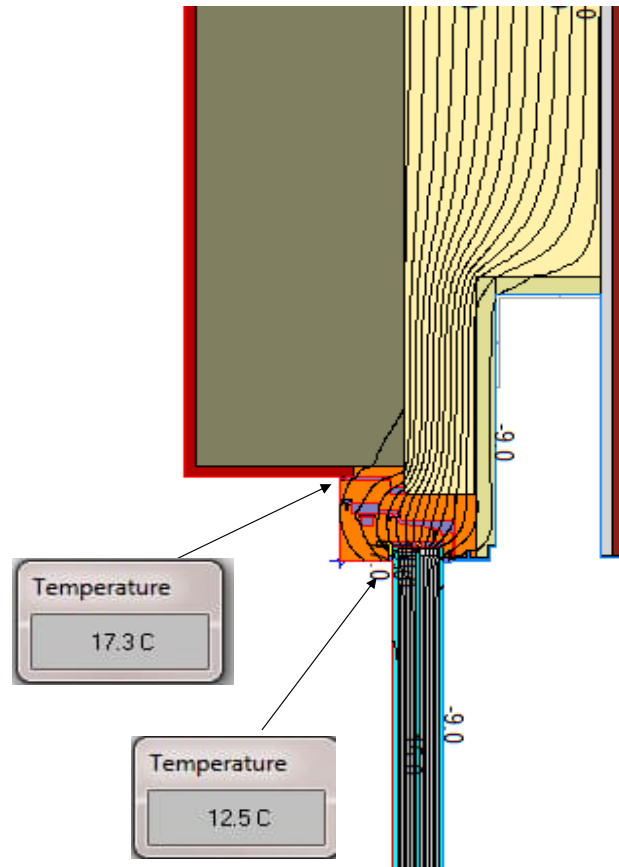
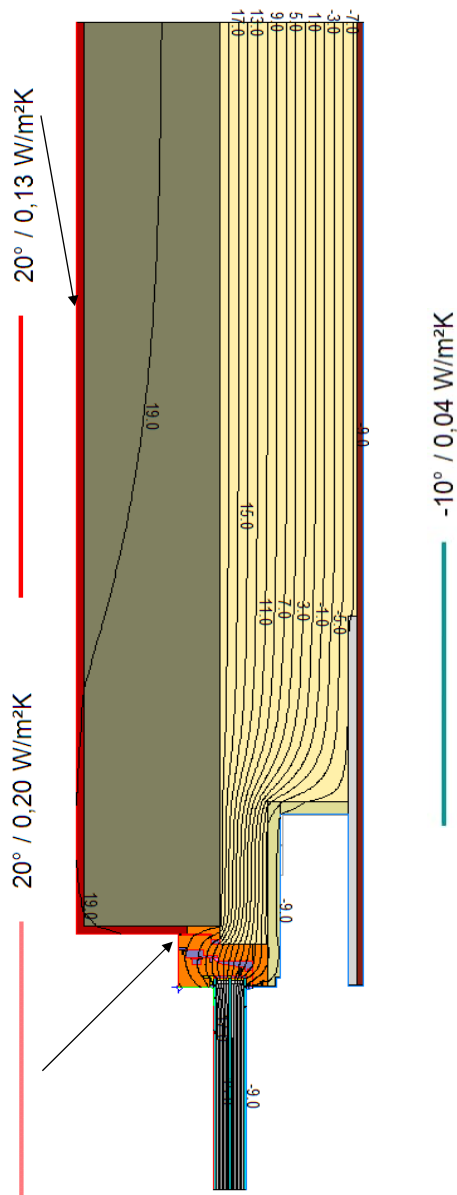

smartwin compact EIFS concrete (WDVS Beton)
venetian blind (Rafflamelle) blindframe (Blindstock)

U_{1D} Wall	0,167	W/m ² K
U_{2D} Window	0,759	W/m ² K
U_{2D}	0,308	W/m ² K



Length S1	1,500	m
Length S2	0,400	m
Total length	1,900	m

L_{1D}	0,553	W/mK
L_{2D}	0,586	W/mK

Ψ_e	0,033	W/mK
----------	-------	------

lowest interior temperature:
 f_{RSI} at 20 °C / -10 °C

projected X
projected X

PHI				
Boundary Conditions	R_s	θ	R_s	θ
	0,13	20,00	0,25	20,00
	0,13	20,00	0,20	20,00
	0,04	-10,00	0,04	-10,00
Psi-value			fR_{si}	

12,5°C	> 0,7 requirement fulfilled
0,75	

Isotherms:

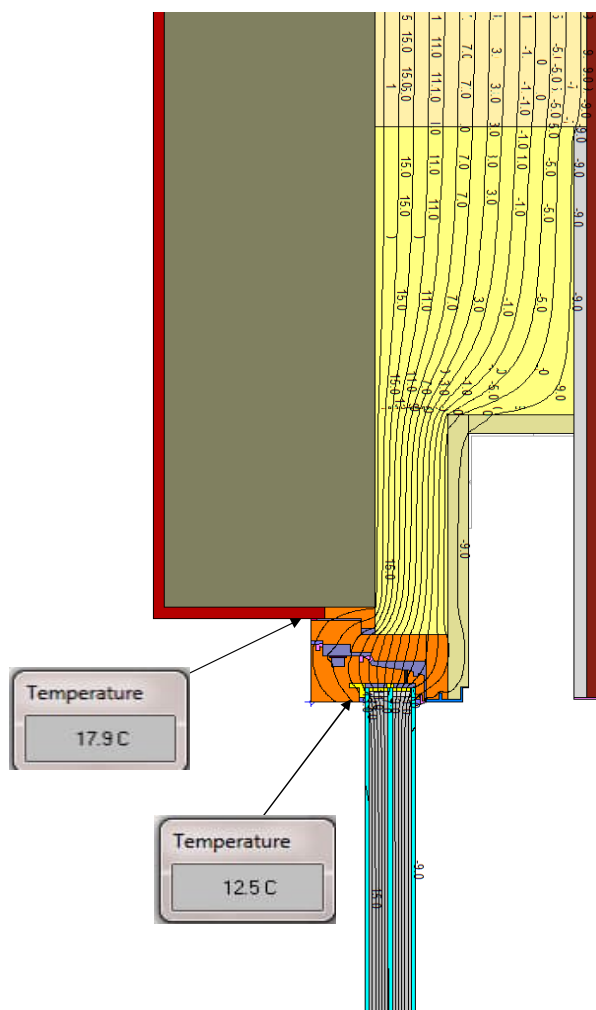
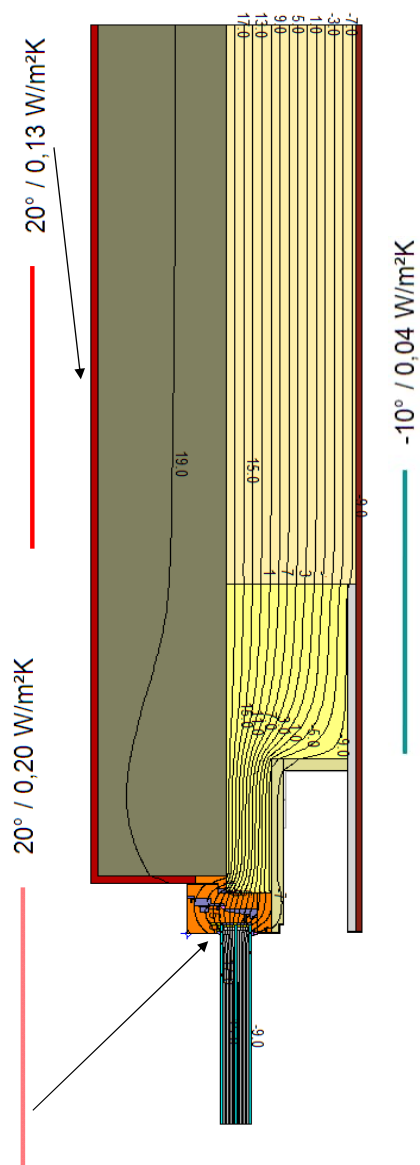

smartwin compact EIFS concrete (WDVS Beton)
venetian blind (Rafflamelle), blindframe (Blindstock)



U_{1D} Wall	0,167	W/m²K
U_{2D} Window	0,759	W/m²K
U_{2D}	0,296	W/m²K

Length S1	1,500	m
Length S2	0,400	m
Total length	1,900	m

L_{1D}	0,553	W/mK
L_{2D}	0,562	W/mK

Ψ_e	0,008	W/mK
----------	-------	------

projected X
projected X

PHI				
Boundary Conditions	R_s	θ	R_s	θ
	0,13	20,00	0,25	20,00
	0,13	20,00	0,20	20,00
	0,04	-10,00	0,04	-10,00
Psi-value			fR_{si}	

lowest interior temperature:
 f_{RSI} at 20 °C / -10 °C

12,7°C
0,76

> 0,7 requirement fulfilled

Isotherms:

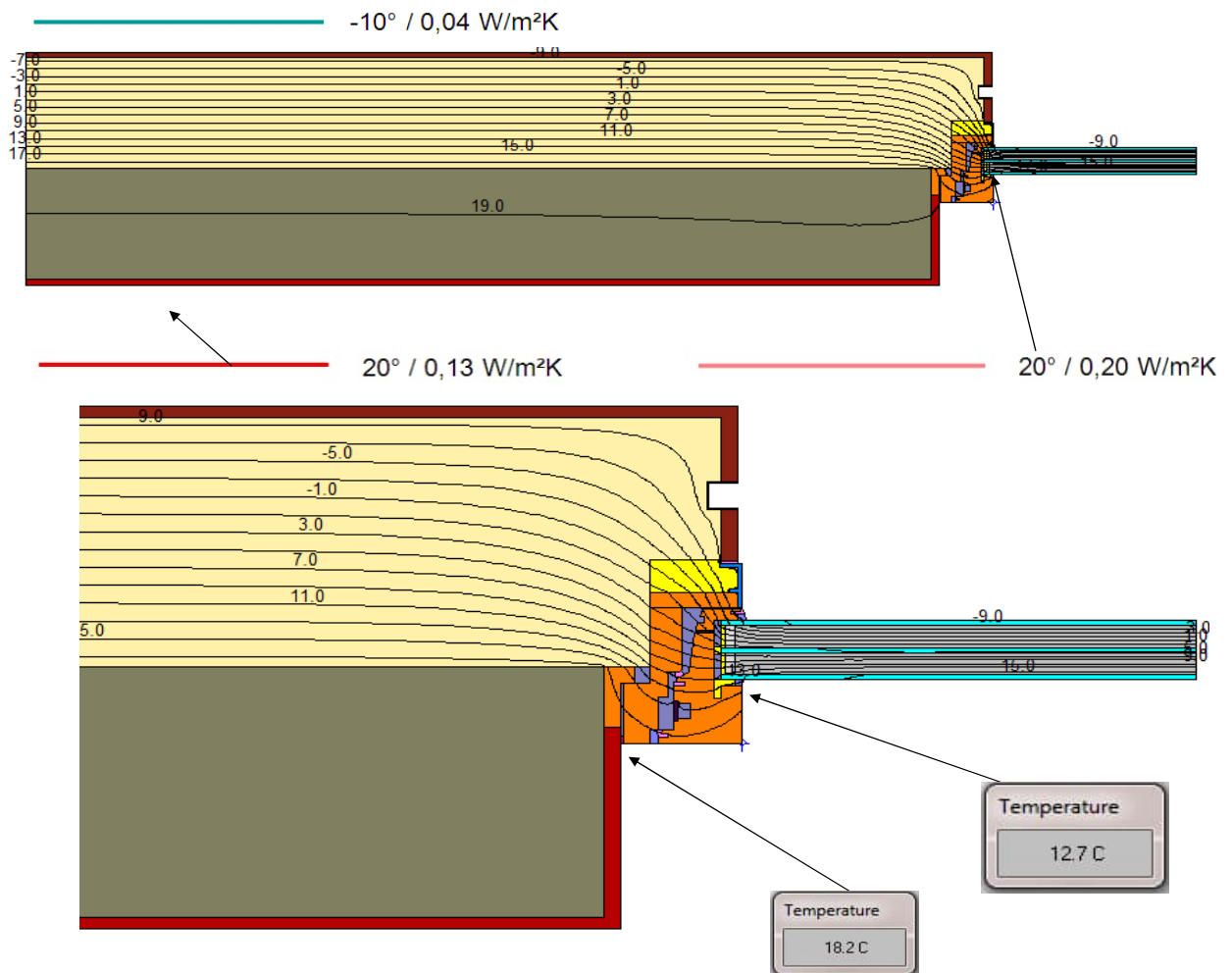

Project

Date 01.08.2018

Signature

F. F. F.

smartwin compact EIFS concrete (WDVS Beton) V2
venetian blind (Rafflamelle), blindframe (Blindstock) V2

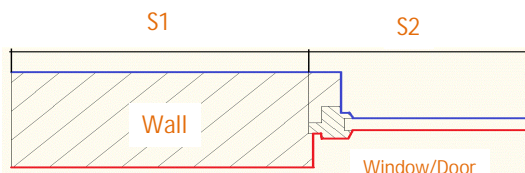



U_{1D} Wall	0,167	W/m ² K
U_{2D} Window	0,759	W/m ² K
U_{2D}	0,296	W/m ² K

Length S1	1,500	m
Length S2	0,400	m
Total length	1,900	m

L_{1D}	0,553	W/mK
L_{2D}	0,563	W/mK

Ψ_e	0,010	W/mK
----------	-------	------

projected X
projected X

PHI				
Boundary Conditions	R_s	θ	R_s	θ
	0,13	20,00	0,25	20,00
	0,13	20,00	0,20	20,00
	0,04	-10,00	0,04	-10,00
Psi-value			fR_{si}	

lowest interior temperature:
 f_{Rsi} at 20 °C / -10 °C

12,7°C
0,76

> 0,7 requirement fulfilled

Isotherms:

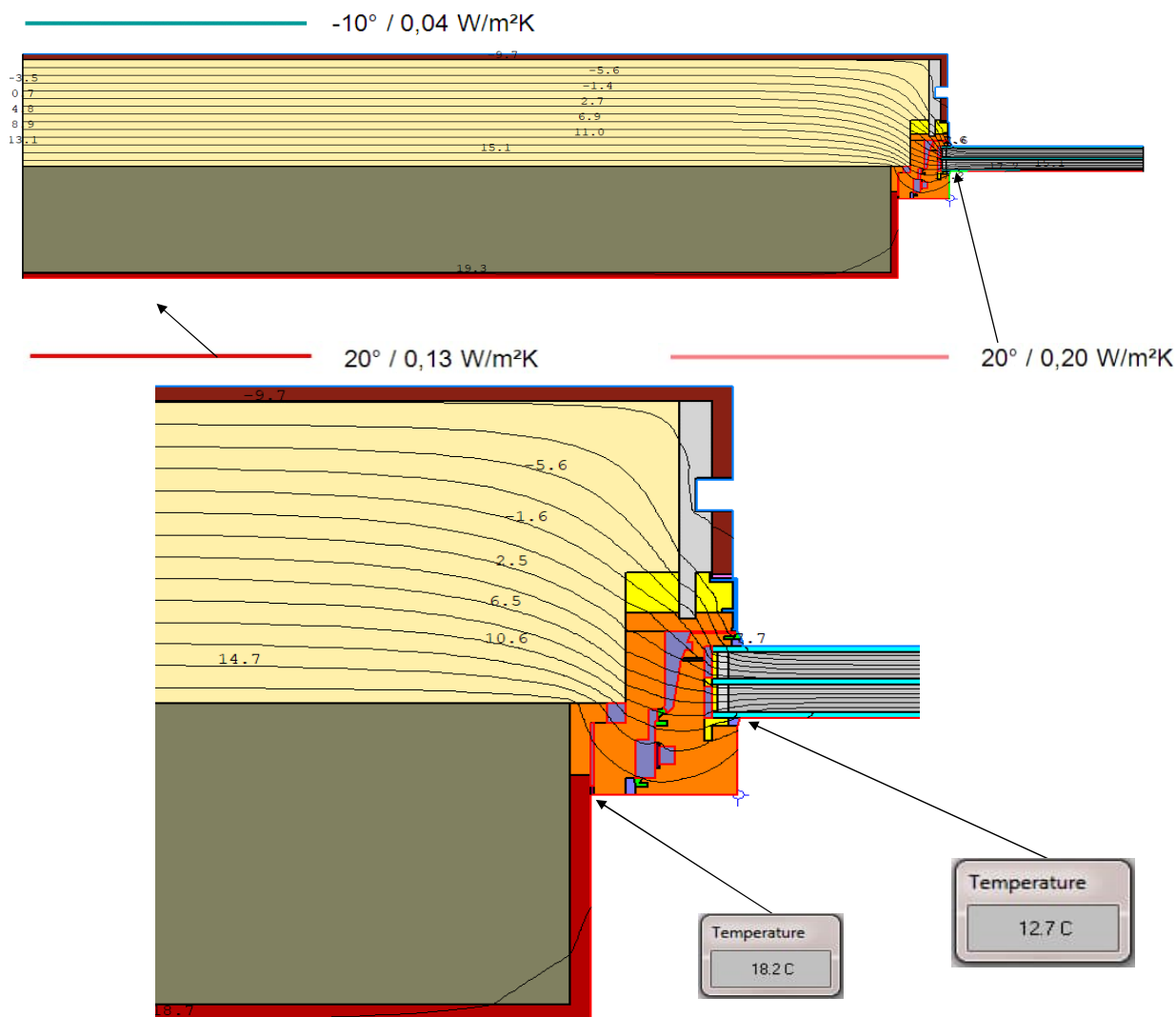

Project

Date 21.10.2020

Signature

F. F. F.

smartwin compact EIFS concrete (WDVS Beton)
blindframe (Blindstock)



U_{1D} Wall	0,167	W/m ² K
U_{2D} Window	0,804	W/m ² K
U_{2D}	0,319	W/m ² K

Length S1	1,500	m
Length S2	0,400	m
Total length	1,900	m

L_{1D}	0,571	W/mK
L_{2D}	0,607	W/mK

Ψ_e	0,036	W/mK
----------	-------	------

projected X
projected X

PHI				
Boundary Conditions	R_s	θ	R_s	θ
	0,13	20,00	0,25	20,00
	0,13	20,00	0,20	20,00
	0,04	-10,00	0,04	-10,00
Psi-value			fR_{si}	

lowest interior temperature:
 f_{RSI} at 20 °C / -10 °C

11,8°C
0,73

> 0,7 requirement fulfilled

Isotherms:

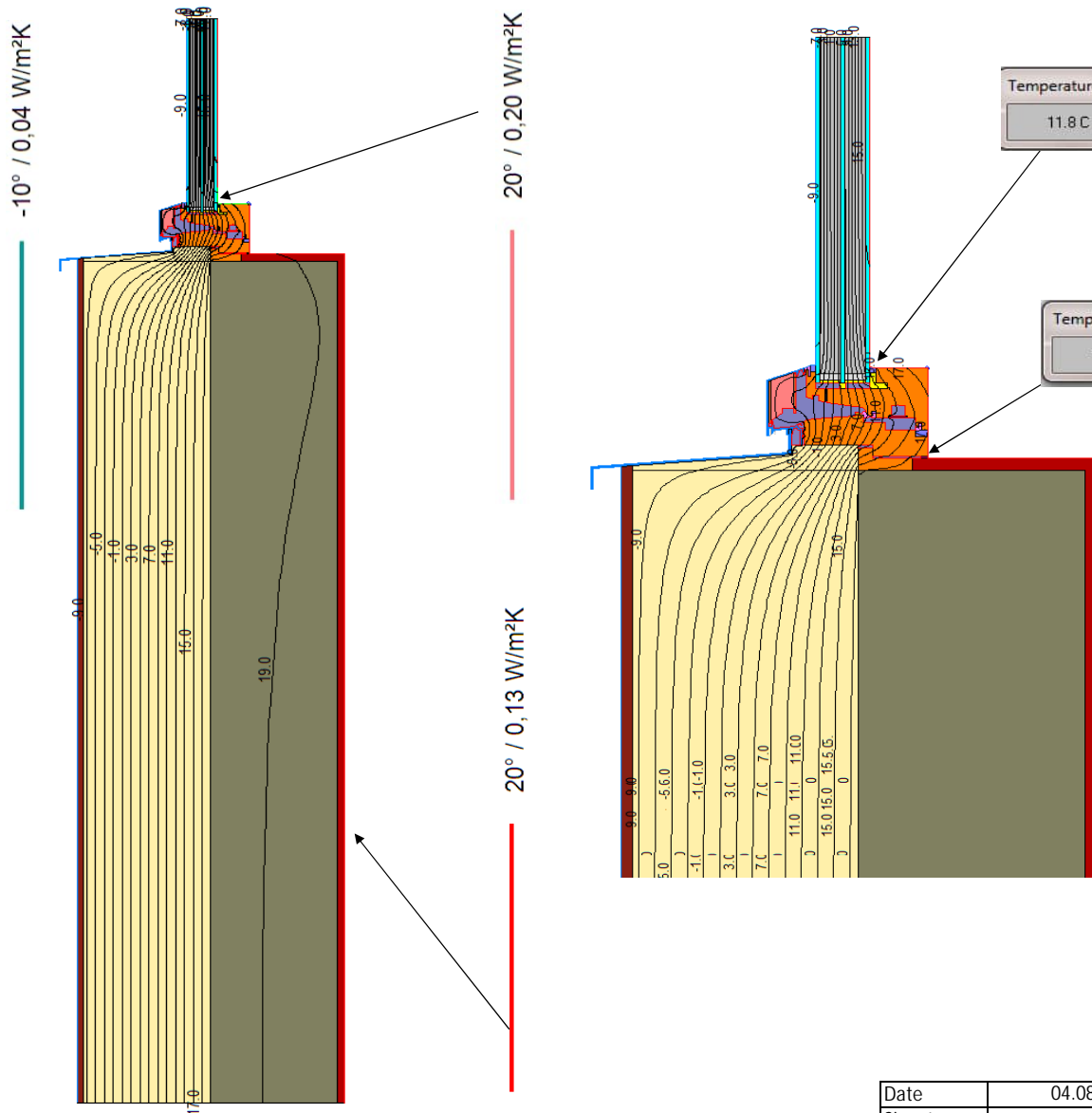

Date	04.08.2018
Signature	



smartwin compact EIFS concrete (WDVS Beton)
venetian blind (Rafflamelle), blindframe (Blindstock)

U _{1D} Wall	0,167	W/m²K
U _{1D} Ceiling	0,108	W/m²K
U _{2D} Window	0,792	W/m²K
U _{2D}	0,172	W/m²K

Length S1	1,005	m
Length S2	0,400	m
Length S3	3,015	m
Total length	4,020	m

L _{1D} Wall	0,101	W/mK
L _{1D} Ceiling	0,271	W/mK
L _{2D} window	0,317	W/mK
L _{2D}	0,691	W/mK

Ψ _e	0,002	W/mK
----------------	-------	------

lowest interior temperature:
f_{RSi} at 20 °C / -10 °C

projected X
custom length (S1+S3) entspricht D21

PHI				
Boundary Conditions	R _s	θ	R _s	θ
	0,13	20,00	0,25	20,00
	0,17	20,00	0,25	20,00
	0,13	-10,00	0,04	-10,00
	0,17	-5,00	0,04	-5,00
	0,13	-5,00	0,04	-5,00
Psi-value			fR _{si}	

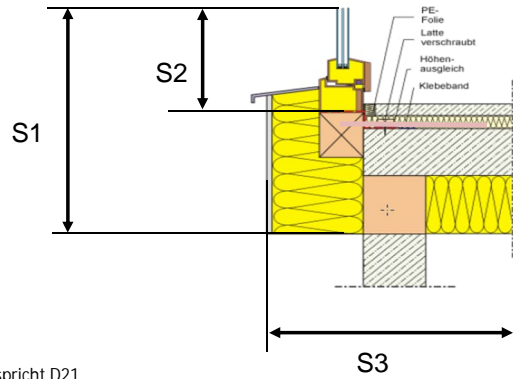

-10° / 0,04 W/m²K

Isotherms:

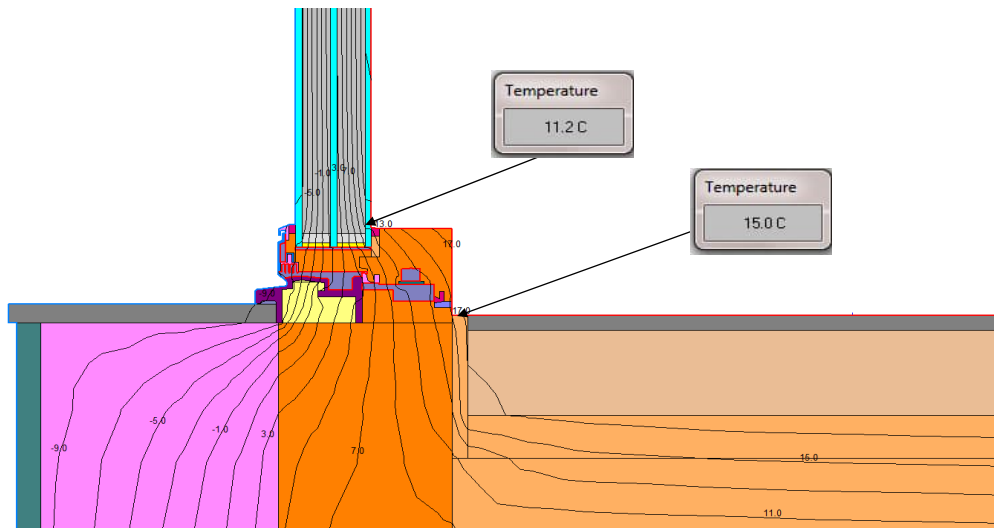
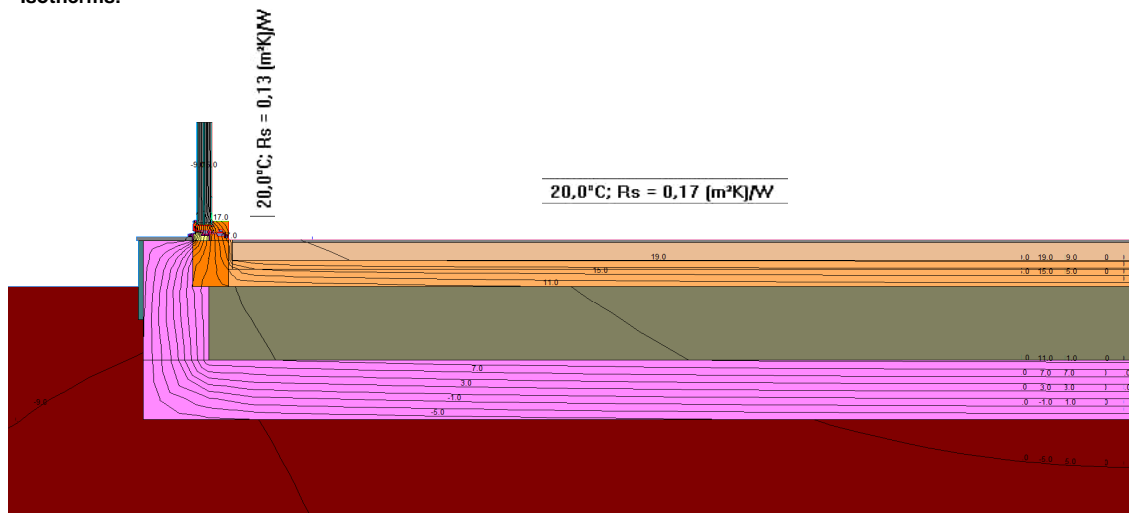

Date 01.08.2018
Signature

F. Fiedler